

# INSTALLATION INSTRUCTIONS

## Troldtekt® acoustic panels and Troldtekt® Plus Installed in exposed T24 profiles in removable, suspended ceiling system

These instructions apply to installation of Troldtekt® acoustic panels and Troldtekt® Plus in exposed T24 profiles in removable, exposed ceiling system. Download installation instructions for Troldtekt® T24 profile system from [www.troldtekt.com](http://www.troldtekt.com).

### PROFILE DRAWINGS

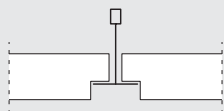

K0-FS: With rebate for exposed T-profile

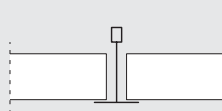

K0-S: Square edge for exposed T-profile

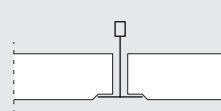

K3-S: With 3 mm rebate for exposed T-profile

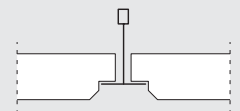

K5-FS: With rebate and 5 mm bevel for exposed T-profile

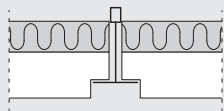

K0-FS: Plus

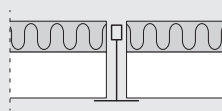

K0-S: Plus

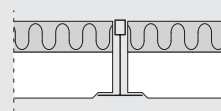

K3-S: Plus

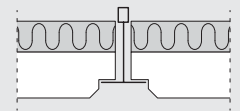

K5-FS: Plus

### INSTALLATION

Check that all hangers are secure after installation of the profile system. Adjust if necessary. Now lay the Troldtekt panels in the grid.

**Note:** When installing 600 × 600 mm square panels, it is important to ensure that the wood wool fibres run mainly parallel in one direction. You can ensure that the panels face the same way by looking at the printed text on the back of the panels. This text must always face the same way.

### ILLUSTRATION - INSTALLATION

